

LERA

LED Elevated Approach, Threshold,
Threshold Wing Bar & Runway End Light



تهران، بزرگراه شیخ فضل ا... نوری، خیابان سازمان آب، خیابان حاجی پور امیر، کوچه مهدی، پلاک ۱
No.1, Mahdi Alley, Haji Pour Amir St., Sazman Aab Ave., Sheikh Fazlollah Nouri Highway, Tehran, IRAN

Email info@tmb-co.com | فکس ۰۲۱۸۸۲۶۰۷۰۷ | تلفن ۰۲۱۸۷۷۴۰ | کدپستی ۱۴۵۴۶۴۳۶۸۵
Web www.tmb-co.com | Fax 98 21 8826 0707 | Tel 98 21 87740 | P.O Box 1454643685



- No optical adjustment after LED module or prism replacement
- Valve for watertightness test after overhaul
- Operating with any topology of CCRs designed in compliance with IEC or FAA requirements

** For monitored fixtures, isolation transformer max size: 200VA*

▶ PERFORMANCES

- The electronic is strong-built and highly resistant to shock and vibration
- Automatic adaptation to the frequency of the supply current
- A surge protection device is provided in the electronics as required by the FAA "Engineering Briefing No.67"
- Immediate detection of an internal fault
- Lightweight and sturdy due to aluminium die-castings
- Powder coating surface finishing to provide good corrosion resistance
- Body balanced on a special support for proper and accurate horizontal and vertical aiming
- High jet blast resistance due to the small size of the Threshold and Runway End fixture, 310 mm high
- Protection degree: IP67
- Temperature range: -45°C to +55°C

▶ INSTALLATION

- The fixture can be installed on pipe elbow or baseplate
- Specific tools available for easy and precise installation

▶ COMPLIANCES

- ICAO** Annex 14 - Volume I Fig. A2-1, A2-2, A2-3, A2-4, A2-8
- EASA** CS-ADR-DSN Fig. U-5, U-6, U-7, U-8, U-12
- FAA** L-862S AC150/5345-46
- IEC** TS 61827
- NATO** STANAG 3316
- CAA** CAP 168 (GB)
- TCCA** TP312 (CDN)
- CASA** MOS 139 (AUS)

▶ APPLICATIONS

Approach, Threshold, Threshold Wing Bar and Runway End for ICAO CAT I, II and III and military runways Used for Stop Bar lighting on ICAO/FAA taxiways

▶ BENEFITS

- 60000 hours LED rated life at full intensity, but over 100000 hours in field operating conditions
- In new installation, LED lights mean lower loads, lower size of CCRs and transformers, thus low life cycle costs
- The light output is variable like a traditional halogen lamp, as indicated by the FAA "Engineering Briefing No.67"
- Colour emitted directly by LEDs : absence of coloured filters ensures no energy losses and no colour shifts
- Fully compatible with existing AFL infrastructure*
- Designed with simplicity allowing longer maintenance intervals and fewer spare parts
- No use of sealant to fix the prisms in the dome thanks to customized gaskets, making their replacement quick and easy



► PHOMETRIC PERFORMANCE

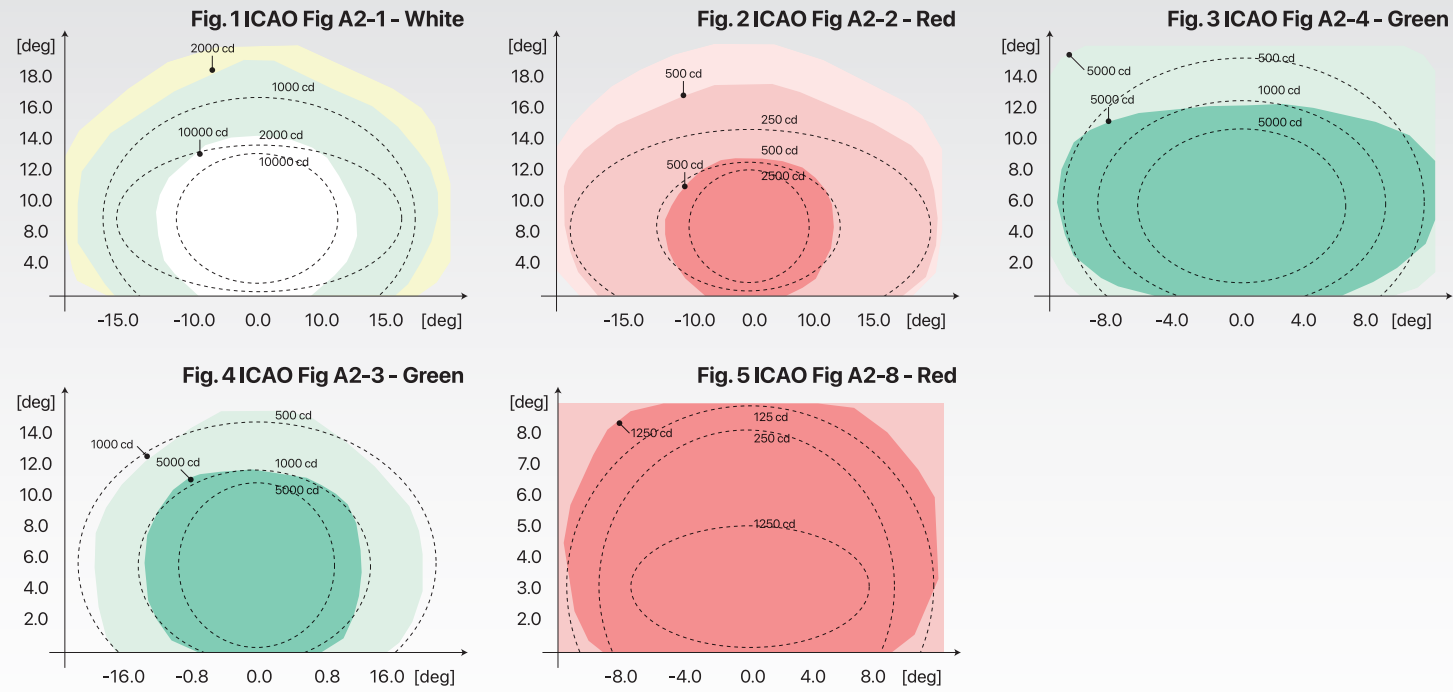

► RENEWAL PARTS FOR LIGHT UNIT

- 1: Cover with electronic
- 2: Cover gasket
- 3: LED module support
- 4: LED module support gasket
- 5: Body
- 6: LED module
- 7: Lens
- 8: Transparent front protection gasket
- 9: Transparent front protection
- 10: Transparent front protection holder plate (painted in the colour of the emitted light)
- 11: Vertical aiming adjusting device
- 12: Special support
- 13: Pole
- 14: Breakable coupling configuration
- 15: Base Plate

*Refer to the relevant technical manual for the complete list

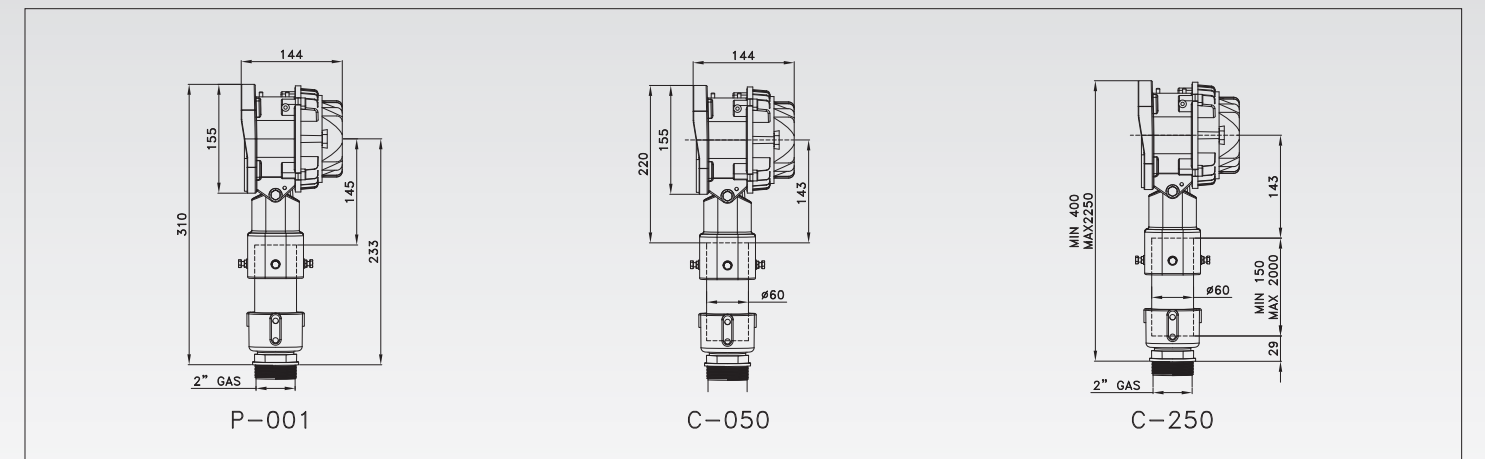

POWER CONSUMPTION (w/o Arctic kit)

Electrical System	1 Plug
Approach White	38 VA
Approach Red	26 VA
Threshold Wing Bar Green	30 VA
Runway End/FAA Stop Bar	20 VA
Stop Bar	17 VA

* Measured at 6.6 A

POWER FACTOR

Input Step	2.8A	6.6A
Power Factor	0.96	0.98

TABLE A

CODE	USE	COLOUR
AC	Approach centreline and crossbars	WHITE
AR	Approach side row	RED
TG	Threshold	GREEN
WG	Threshold wing bar	GREEN
ER	Runway end	RED
BA	Stop bar	RED

SHIPPING WEIGHTS & VOLUMES

	Light Type P-001	Light Type C-050	Light Type C-250
Weight (kg)	4.4	4.1	5.0
Volume (m ³)	0.019	0.019	0.019

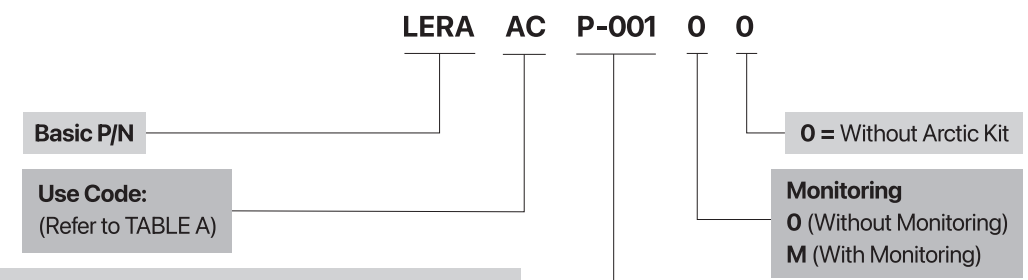

Configuration:
 P-001 = Fixture complete with breakable coupling
 C-050 = Fixture with special support and cable lead (L= 0.5 m) (*)
 C-250 = Semi-assembled fixture (AC and AR only) (*) (**)
 C-000 = Fixture without cable lead (*)

(*) Pole and breakable coupling must be ordered separately
 (**) This configuration is provided with cable lead of L = 2.5 m